

# SurePath™ is Easy to Use.

SurePath™ offers several collection device choices.

## Option 1

SurePath™ Sample Collection with Broom-Type Device with Detachable Head<sup>5</sup>

### 1. Collect

Insert the Rovers Cervix-Brush® into the endocervical canal. Rotate brush five times in a clockwise direction.



### 2. Drop

Drop the detachable head of the device into the SurePath™ vial.



### 3. Send

Place the cap on the vial and tighten. Send the SurePath™ vial to the lab for processing.



Contraindication: The Cervex-Brush® should not be used on patients after the first 10 weeks of pregnancy.

## Option 2

SurePath™ Sample Collection with Combination Brush/plastic Spatula Device with Detachable Heads<sup>6</sup>

### 1A. Collect

Insert the contoured end of the Pap Perfect® plastic spatula and rotate 360° around the entire exocervix.



### 1B. Collect

Insert Cytobrush® Plus GT into the endocervix until only the bottom-most bristles are exposed at the os. Slowly rotate 1/4 to 1/2 turn in one direction. To reduce unnecessary bleeding, do not over-rotate brush.

### 2A. Drop

Snap the device handle and drop the detachable head of the device into the SurePath™ vial.



### 2B. Drop

Snap the device handle and drop the detachable head of the device into the SurePath™ vial.

### 3A. Next

Place cap on vial; do not tighten cap until 'Step #3B Send.' Go to Cytobrush® Plus GT 'Step #1B. Collect.'



### 3B. Send

Place the cap on the vial and tighten. Send the SurePath™ vial to the lab for processing.

Warning: Do Not Use Cytobrush® Plus GT on pregnant patients or for endometrial sampling. See SurePath™ Sample Collection Kit product insert for complete Directions for Use.

## Alternative Methods to Detach Heads of Collection Devices:

### Two-Hand 'SNAP'<sup>6</sup>



Do not touch the head of the device while detaching.

## Alternative Methods to Detach Heads of Collection Devices:

### Cap-assisted 'SNAP'<sup>6</sup>

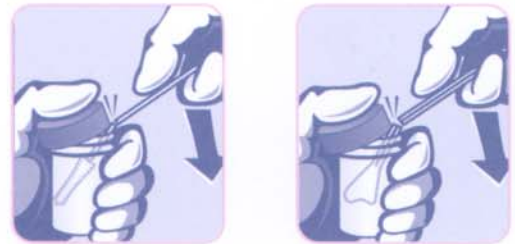

Care must be taken to avoid splashing and/or contamination of the head(s) of the device(s).

from **TRIPATH-IMAGING**

Now You're Sure.™

**SUREPATH™**  
liquid-based Pap test